

JT REAR INNER FENDERS

21+ JEEP GLADIATOR
INFEND-07RB



TOOLS REQUIRED

- 13mm Socket
- 4mm Allen Tool
- 10mm Wrenches
- Trim Clip Tool
- Safety Glasses

SKILL LEVEL

- Novice/Intermediate
 - 1 (you) to 2 persons
- Little skill level required, you can easily install it by yourself however, additional help will be useful

TIME REQUIRED

- 2 Hours
- Time to install this should only take about two hours.

WARNINGS/CAUTIONS BEFORE STARTING INSTALLATION

Before you install this kit – Read and understand all instructions, warnings, cautions, and notes contained in this installation instruction guide. Consult your vehicle owner's manual for proper disconnection of electrical and lifting of vehicle if required for installation of this product.

This install may require some technical skills and knowledge of basic mechanical work. If you do not feel that you are capable of performing this install please take this product to a trained professional.

After reading this guide please contact us with any questions or concerns before installing product.
Customer Service: 855-680-9595

DV8 Offroad is not responsible for any bodily injury or harm to you or your vehicle as a result of an improper install.

Proper installation of this kit required knowledge of the factory recommended procedures for removal and installation of original equipment components. We recommend that the factory shop manual and any special tools needed to service your vehicle be on hand during the installation. Installation of this kit without proper knowledge of the factory recommended procedures may affect the performance of these components and the safety of the vehicle

- Always wear eye protection when operating power tools

Inspect all contents of this package to make sure product is not damaged and all installation hardware has been included. If parts are missing from kit, please be prepared to provide the following information

1. Name of purchase location
2. Bar Code on side of box
3. Date above bar code
4. Date inside box cover



INSTALLATION MANUAL

Begin by unpacking all items and inspecting for missing pieces or damage. If you have any concerns, please contact the company the product was purchased from. Extra hardware may be included with the product.

HARDWARE INCLUDED

- (8) M6x20mm Bolts
- (26) M6 Lock Nuts
- (52) M14 Flat Washers
- (18) M6x16mm Bolts
- (2) Push Pins

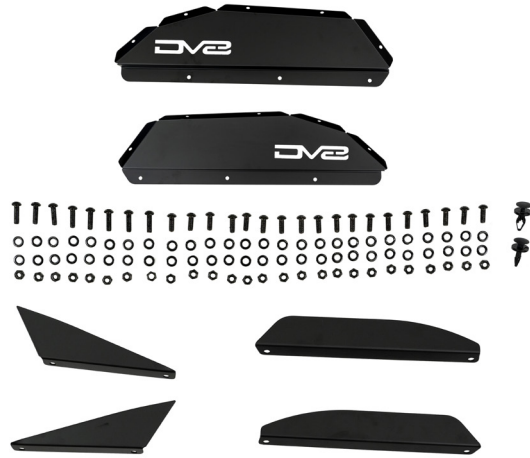

STEP 1 | Use a 8mm socket to remove the bolts located along the interior of the inner fender.

Then, use a trim clip tool to remove the clips located in each corner of the fender.



INSTALLATION MANUAL



STEP 2 | Use a trim clip tool to pry the (2) plastic rivets securing the factory inner fender to the factory fender flare.

Separate the factory inner fender from the factory fender flare and remove the inner fender.



STEP 3 | Use a trim clip tool to pry the (2) electrical plugs from the factory frame bracket on each side.

Remove the harness clips securing the wiring harness to the beds underside on each side.





STEP 4 | Using a 13mm socket remove the electrical frame brackets from each side.

Tuck the wiring harness and plug connections behind the frame. Use zip ties to secure any loose wiring.

Note: These brackets will not be reused.



INSTALLATION MANUAL

STEP 5 | Layout the (4) Inner fender panels for each side as shown.



STEP 6 | Lay the large wheel well panel into the center section as shown.

Use the provided M6x16 hardware, #4 Allen too and a 10mm wrench to secure the two panels together.

Use (1) M6 washer on each side of the panel.

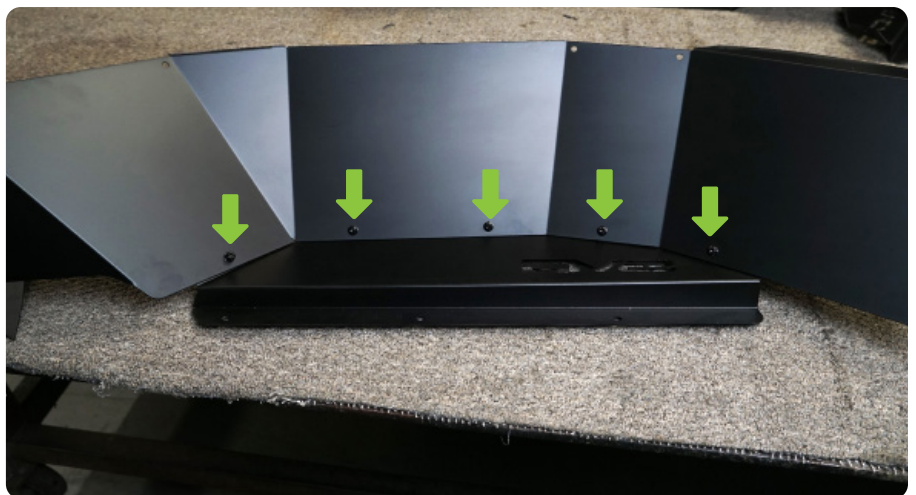

INSTALLATION MANUAL

STEP 7 | Install the front wheel well extension panel behind the large wheel well panel as shown.

Use the provided M6x16 hardware, #4 Allen too and a 10mm wrench to secure the two panels together.

Use (1) M6 washer on each side of the panel.

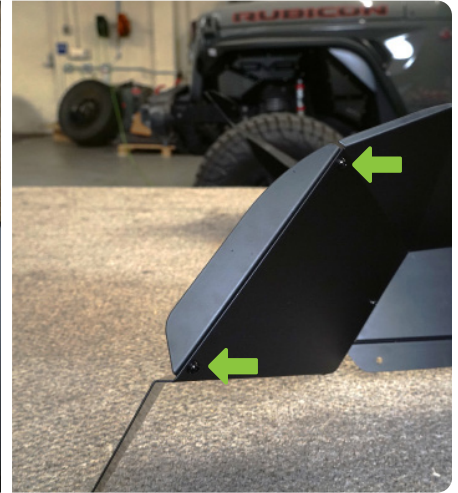

STEP 8 | Install the rear wheel well extension panel behind the large wheel well panel as shown.

Use the provided M6x16 hardware, #4 Allen too and a 10mm wrench to secure the two panels together.

Use (1) M6 washer on each side of the panel.

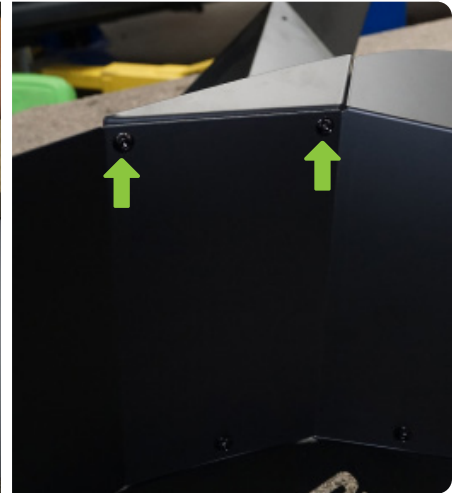
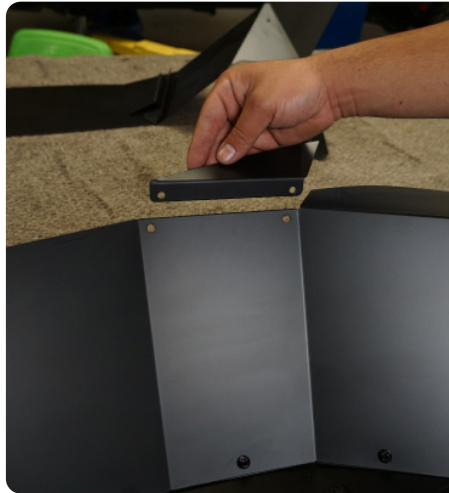

STEP 9 | Place the rear of the inner fender inside the wheel well first, then bring the front section up ensuring all panels are behind the fenders pinch welds.





STEP 10 | Use the provided M6x20 hardware to secure the inner fender/center panel to the wheel well.

Use a 10mm wrench and a #4 Allen tool to secure the hardware. Use (1) M6 washer on each side of the panel.



INSTALLATION MANUAL



INSTALLATION MANUAL

STEP 11 | Secure the rear section of the inner fenders to the fender pinch weld.

If you are running DV8 rear fenders, secure the inner fender to the fenders M6 mounting bolt.

If you are running factory fenders, use the provided push pin to secure the inner fender.



STEP 12 | Use the provided push pin to secure the front of the inner fender to the vehicle.

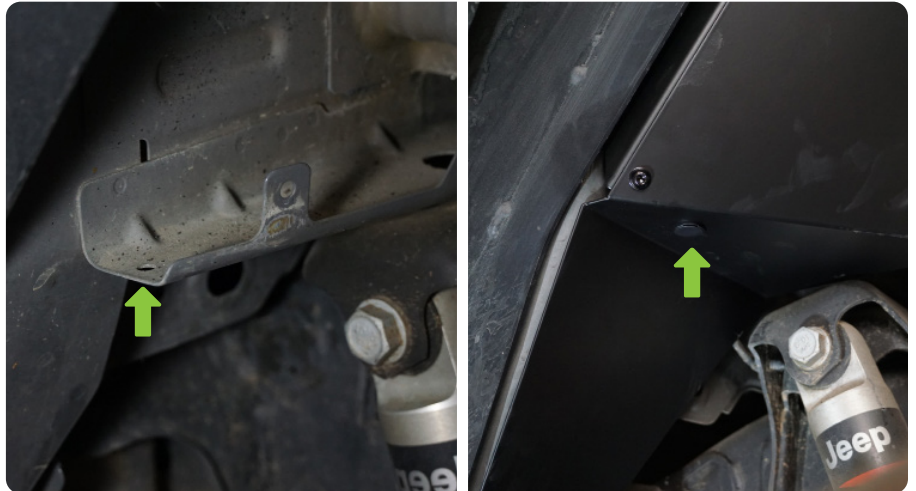

STEP 13 | Double check that all hardware is secured.

Congratulations, installations of the DV8 Inner Fenders is not complete.

