

## GX470 REAR WINDOW INTERIOR MOLLE PANEL

2003-2009 LEXUS GX470



### TOOLS REQUIRED

- Nutsert Tool
- Trim Removal Tool
- 4mm Allen Bit
- 10mm Wrench
- Philips Head Screwdriver
- Drill
- 11/32" Drill Bit or Stepped Drill Bit
- Boxcutter or Knife

### SKILL LEVEL

- Novice/Intermediate
  - 1 (you) to 2 persons
- Little skill level required, you can install it by yourself however, additional help will be useful

### TIME REQUIRED

- 1.5 Hours
- Time to install this should only take about an hour and a half

## WARNINGS/CAUTIONS BEFORE STARTING INSTALLATION

Before you install this kit – Read and understand all instructions, warnings, cautions, and notes contained in this installation instruction guide. Consult your vehicle owner’s manual for proper disconnection of electrical and lifting of vehicle if required for installation of this product.

This install may require some technical skills and knowledge of basic mechanical work. If you do not feel that you are capable of performing this install please take this product to a trained professional.

After reading this guide please contact us with any questions or concerns before installing product.  
Customer Service: 855-680-9595

*DV8 Offroad is not responsible for any bodily injury or harm to you or your vehicle as a result of an improper install.*

Proper installation of this kit required knowledge of the factory recommended procedures for removal and installation of original equipment components. We recommend that the factory shop manual and any special tools needed to service your vehicle be on hand during the installation. Installation of this kit without proper knowledge of the factory recommended procedures may affect the performance of these components and the safety of the vehicle

- Always wear eye protection when operating power tools

*Inspect all contents of this package to make sure product is not damaged and all installation hardware has been included. If parts are missing from kit, please be prepared to provide the following information*

1. Name of purchase location
2. Bar Code on side of box
3. Date above bar code
4. Date inside box cover

# INSTALLATION MANUAL

Begin by unpacking all items and inspecting for missing pieces or damage. If you have any concerns, please contact the company the product was purchased from.

## HARDWARE INCLUDED

- (16) M6x16 Allen
- (4) M6x12 Allen
- (4) M6 Spring Washers
- (36) M6 Flat Washers
- (12) M6 Nylon Lock Nuts
- (2) Aluminum Spacers
- (4) M6x14 Nutserts



**STEP 1** | Install the wider “L” shaped bracket behind the logo on the molle panel and secure using provided M6x16 hardware. Use a 4mm allen bit and 10mm wrench.

*Tip: M6x12 is the shortest hardware in the kit. It will be used near the end of the install.*

*Pictured is the installation of the driver side molle panel.*



# INSTALLATION MANUAL

**STEP 2 |** Install two of the smaller “L” shaped brackets onto the bracket with the bend facing towards the side with the logo.

The brackets can be adjusted forward to have the panels sit flush with the window, or backward to have it stick into the cab more. For our installation, they are adjusted to sit flush with the window.

Secure using the provided M6x16 hardware with a 4mm allen bit and 10mm wrench.



**STEP 3 |** Moving the interior of the vehicle, undo the clips on the handle located above the rear windows.

Remove the bolts securing the handle using a philips head screwdriver and remove the handle.

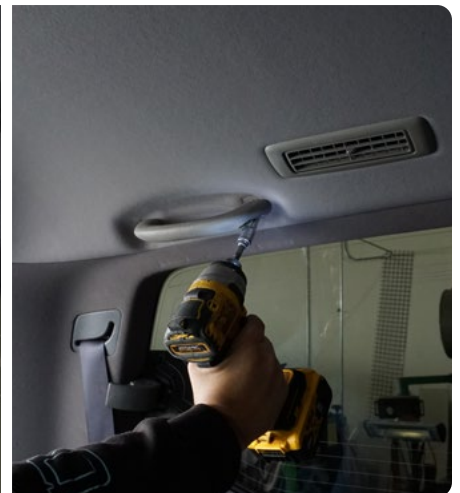

# INSTALLATION MANUAL

**STEP 4 |** Install the molle panel utilizing the factory mounting points and hardware with a philips head screwdriver.



**STEP 5 |** Loosely install the aluminum spacers at the bottom of the molle panel using the provided M6x12 hardware (This is the shortest hardware provided). Use a 4mm allen bit if necessary.

Adjust the up and down position to your liking and tighten the factory bolts to prevent it from shifting when finished.



**STEP 6 |** Mark the mounting holes for drilling by slowly pushing the panel against the body of the vehicle and marking with sharpie where the threaded stud lands.

Once marked, remove the entire assembly to prepare for drilling by removing the factory bolts with a philips head screwdriver.



# INSTALLATION MANUAL

**STEP 7** | To prepare for drilling, you may choose to cut a small hole in the fabric to drill through to prevent the bit from pulling on the fabric.

Drill out the marked holes to 11/32" and install the provided M6 nutserts using a nutsert tool.

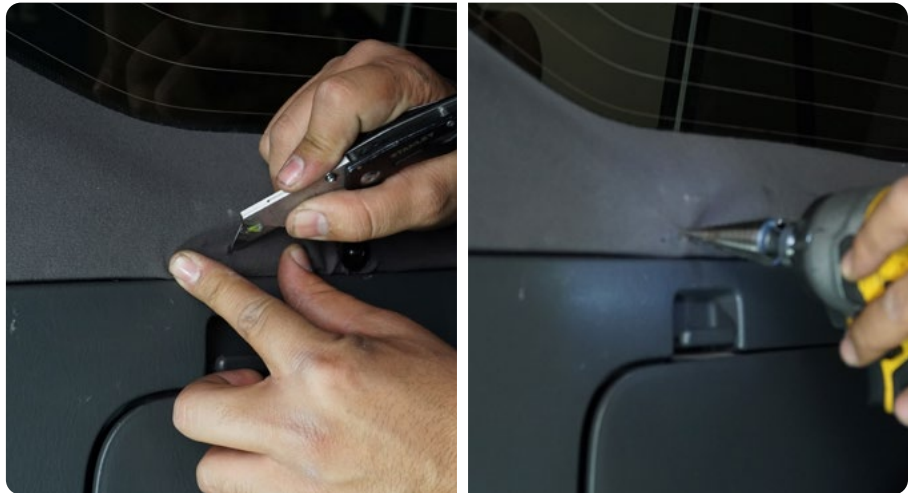

**STEP 8** | Secure the aluminum spacers into the rivnuts.



# INSTALLATION MANUAL

**STEP 9** | Install molle panel utilizing the factory mounting holes and bolts with a philips head screwdriver. You can re-install the handles on top of the brackets if desired.



**STEP 10** | Secure the bottom of the molle panel to the aluminum spacers using the M6x12 hardware (This is the shorted hardware provided) and a 4mm allen bit.

Double check all hardware is secure.

Repeat steps 1-10 for passenger side of vehicle.



**STEP 11** | Congratulations! You are finished with the install of the Lexus GX470 Rear Window Interior Molle Panels.

