

## TUBE SPARE TIRE CARRIER

07-18 JEEP JK

TCJK-14



### TOOLS REQUIRED

- 12-16ft wire for license plate light
- Trim tool, grinder, hammer, punch, drill, 3/8" drill bit
- Adjustable wrench, 17mm wrench
- 7, 10, 13, 15, 17mm socket
- T50, #5, #7, #12 Allen head
- Safety Glasses

### SKILL LEVEL

- Intermediate
  - 2 person
- Moderate skill level required, you can easily install it by yourself.

### TIME REQUIRED

- 4.5 Hours
- Time to install this should only take about four and a half hours.

## WARNINGS/CAUTIONS BEFORE STARTING INSTALLATION

Before you install this kit – Read and understand all instructions, warnings, cautions, and notes contained in this installation instruction guide. Consult your vehicle owner's manual for proper disconnection of electrical and lifting of vehicle if required for installation of this product.

This install may require some technical skills and knowledge of basic mechanical work. If you do not feel that you are capable of performing this install please take this product to a trained professional.

After reading this guide please contact us with any questions or concerns before installing product.  
Customer Service: 855-680-9595

*DV8 Offroad is not responsible for any bodily injury or harm to you or your vehicle as a result of an improper install.*

Proper installation of this kit required knowledge of the factory recommended procedures for removal and installation of original equipment components. We recommend that the factory shop manual and any special tools needed to service your vehicle be on hand during the installation. Installation of this kit without proper knowledge of the factory recommended procedures may affect the performance of these components and the safety of the vehicle

- Always wear eye protection when operating power tools

*Inspect all contents of this package to make sure product is not damaged and all installation hardware has been included. If parts are missing from kit, please be prepared to provide the following information*

1. Name of purchase location
2. Bar Code on side of box
3. Date above bar code
4. Date inside box cover



# INSTALLATION MANUAL

Begin by unpacking all items and inspecting for missing pieces or damage. If you have any concerns, please contact the company the product was purchased from. Extra hardware may be included with the product.

## HARDWARE INCLUDED

- (1) M14x35mm Hexagonal socket bolt
- (1) M14x25mm Hexagonal socket bolt
- (2) M14 Lock Nuts
- (3) M14 Flat Washers
- (2) M10x35mm Hexagonal socket bolt
- (6) M10 Flat Washers
- (4) M10 Nylon Lock nuts
- (6) M8x30mm Hex bolts
- (8) M8x30mm Hexagonal socket bolt
- (11) M8x30 Countersunk head bolts
- (5) M8 Nylon Lock Nuts
- (5) M8 Enlarge Washers
- (6) M8 Washers
- (6) Spring Washers
- (4) .5mm Nylon Spacers
- (4) 1mm Nylon Spacer
- (2) M6x20 Allen Head bolts
- (2) M6 Lock Nuts
- (4) M6 Large Washers
- (2) M4 Phillips head bolts and nuts
- (2) M5x20 Taper head allen bolts
- (2) M10 Hinge Bolts



**STEP 1** | Remove the spare tire from the vehicle.



# INSTALLATION MANUAL

**STEP 2 |** Open the tailgate and use a trim clip tool to remove the trim panel on the tailgate taking care to not break the tabs.

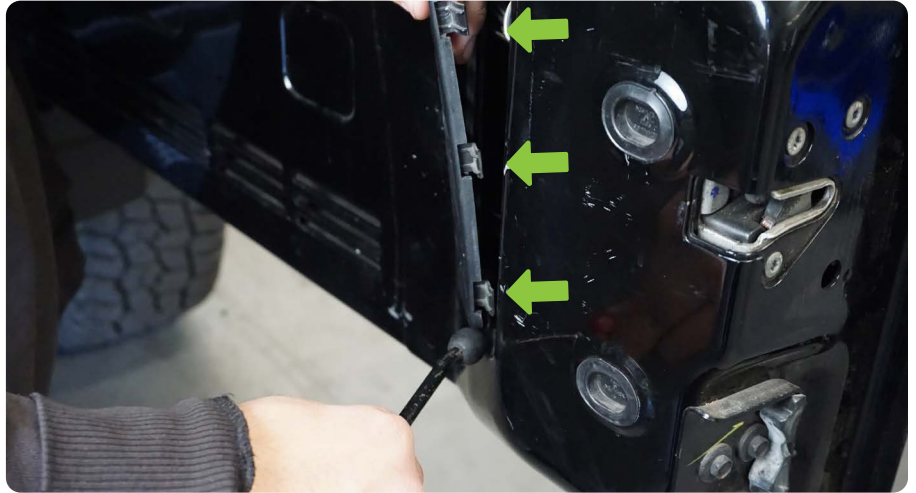

**STEP 3 |** Disconnect the third brake light wiring harness. Small gray plug shown in image.

Use a trim clip tool, if necessary since plug can become stuck.



**STEP 4 |** With the light unplugged, push the rubber grommet holding the wire towards the outside (back) of the vehicle. Pull disconnected plug through hole in rear door.



## INSTALLATION MANUAL

**STEP 5 |** Remove the rubber tire stoppers by pulling them out.

If you must use a trim clip tool, be careful not to scratch the paint. Clean surface of any dirt.



**STEP 6 |** Use a 13mm socket to remove the (8) factory bolts securing the tire carrier to the vehicle, set the carrier off to the side.



# INSTALLATION MANUAL

**STEP 7 |** Before you remove any door hardware, using a bent piece of cardboard or other material, support the passenger side of the rear door so it does not fall when hinges are removed.

Use a trim clip tool to remove the plastic hinge covers. Use a 13mm socket to remove the hinge to tailgate bolts. (2) per hinge



**STEP 8 |** Use a T50 Torx tool to remove the hinge to body mounting bolts. (3) per hinge



**STEP 9 |** Place the hinge in a vice as shown. Use a grinder to grind down the hinge pin flush.





**STEP 10** | Use a punch and hammer to knock out the hinge pin.

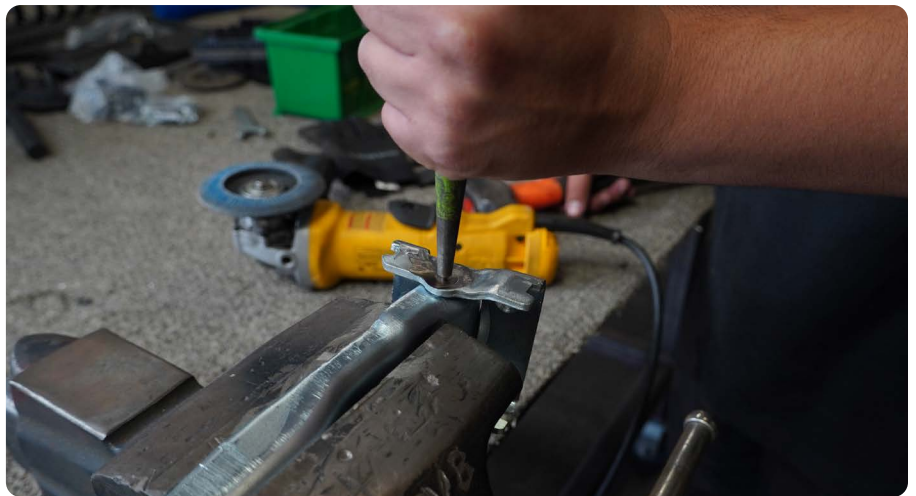

# INSTALLATION MANUAL

**STEP 11** | Separate the hinge in to two pieces.

Remove the hinge pins collars.



# INSTALLATION MANUAL

**STEP 12** | Provided in the hardware kit are (4) .5mm and (4) 1mm nylon spacers to be used when connecting tailgate portion of the factory jeep hinge with the provided DV8 body bracket.



**STEP 13** | Place a 1mm spacer on each side of the factory hinge to start and insert the provided hinge pin to check side to side spacing.

Add additional spacers as needed to reduce factory hinge to DV8 body bracket spacing and prevent side to side movement of the factory hinge between the DV8 body bracket.

For this install we used an .5mm and 1mm on each side of the factory hinge.





# INSTALLATION MANUAL

**STEP 14** | Use a (1) M10 washer, (1) M10 nylon locking nut and a 17mm socket to loosely secure the hinge pin in place.

The washer will be use don the nut side of the bolt.



**STEP 15** | Loosely mount the completed hinge assembly on to the vehicle using the provided M8x30 Counter sunk head bolts and a #5 Allen tool.



**STEP 16** | Use a 13mm socket and the factory hardware to loosely secure the hinges to the tailgate.



# INSTALLATION MANUAL

**STEP 17** | Use a trim tool to lift the latch/handle of the tailgate up to align the vehicles body lines. Use cardboard to prop the driver side of the tailgate up and keep body lines aligned.



**STEP 18** | Use a trim tool to lift the hinge side of the tailgate up and align the body lines.

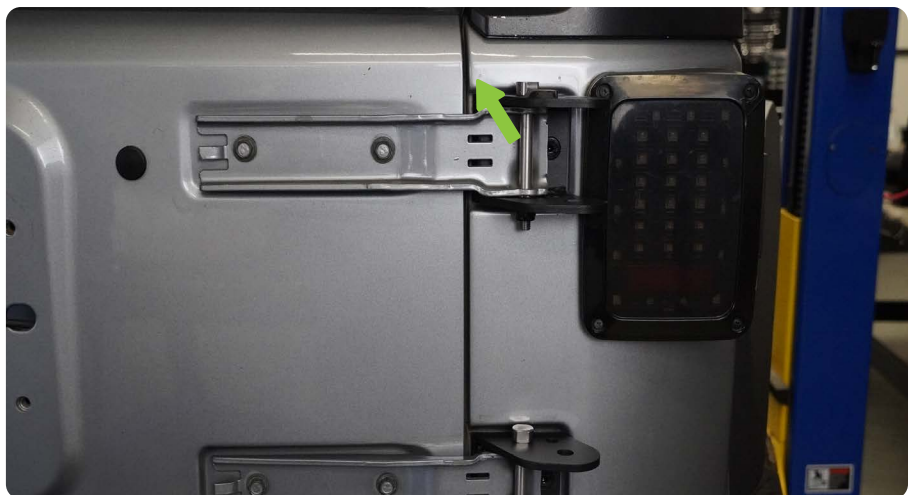

# INSTALLATION MANUAL

**STEP 19** | With the body lines aligned on both sides, secure the factory hinge bolts using a 13mm socket.

At this time secure the DV8 hinge bracket as well using a #5 Allen tool.



**STEP 20** | Remove the driver side tail light at this time using a Phillips head screwdriver.

Unplug the tail light electrical connections and set the tail light off to the side.





**STEP 21** | If equipped remove the factory license plate housing.

Remove the license plate to gain access to the (2) upper hex head bolts securing the license plate housing.

Use a 7mm socket to remove the (2) upper hex head bolts.





**STEP 22** | Use a trim tool to pry the plastic cover away from the housing to gain access to the license plate light electrical plug.



# INSTALLATION MANUAL

**STEP 23** | Disconnect the license plate light electrical plug and set the cover off to the side, it will not be used with the DV8 tire carrier.



**STEP 24** | To gain access to the housings (2) lower mounting hex bolts, use a 15mm socket to disconnect the bumper from the bumper support on the drive side only.



# INSTALLATION MANUAL



**STEP 25** | With the bumper support disconnected you can flex the bumper down enough to use a 7mm socket to remove the housings (2) lower mounting hex bolts.



**STEP 26** | Use a pick tool to lift up and release the (2) plastic retaining clips.

Remove the housing and set it off to the side, it will not be used with the DV8 tire carrier.





**STEP 27** | Push the factory license plate light wiring harness back into the body of the jeep.



**STEP 28** | Clean off any dirt from where the license plate housing was mounted and install the provided license plate cover.

The cover is shipped with double sided tape pre-installed.





# INSTALLATION MANUAL

**STEP 29** | Assemble the tire carrier cage using the provided M8 hardware and a #6 Allen tool.

**WE HIGHLY RECOMMEND CLEANING THESE THREADS WITH A TAP OR RUNNING THE HARDWARE THROUGH THEM PRIOR TO ASSEMBLY.** These have grease in them for the coating process and can prevent easy installation during assembly.

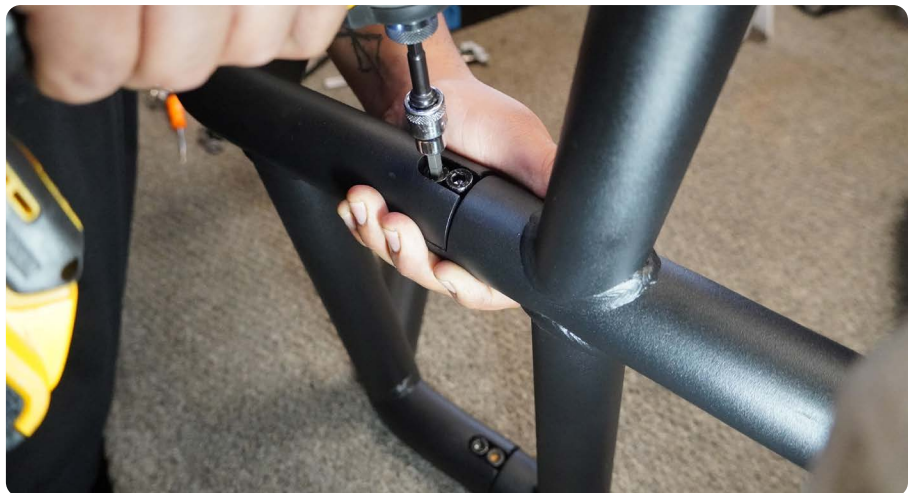

# INSTALLATION MANUAL

**STEP 30** | Sandwich the license plate bracket between the tire carrier cage and the tire spindle as shown.



**STEP 31** | Secure the license plate bracket and tire spindle to the tire carrier cage using the provided M8 hardware and a 13mm socket.

Use (1) flat washer and (1) lock washer per M8 bolt.





**STEP 32** | With the tire carrier assembly complete attach the tire carrier to the DV8 hinge bracket.



**STEP 33** | Using a 12mm Allen tool and adjustable wrench, loosely secure the tire carrier to the top hinge using the provided M14x34mm bolt, Cam nut, M14 flat washer and M14 nylon lock nut.

**Note:** Use the M14 flat washer on the lock nut side of the bolt.



# INSTALLATION MANUAL

**STEP 34** | Using a 12mm Allen tool and adjustable wrench, loosely secure the bottom hinge using the provided M14x25mm bolt, flat washers and nylon locking nut.

Use (1) washer at the top of the bolt and (1) washer on the lock nut side of the bolt.



**STEP 35** | Install the (2) M10 x35mm into the hinge brackets as shown. **Do not tighten these down until after the carrier is adjusted fully in Step 46.**

These bolts are used to stop the tire carrier from swinging into the tail light.



**STEP 36** | Install the rubber cone on to the tire carrier spindle and the install the tire as shown.

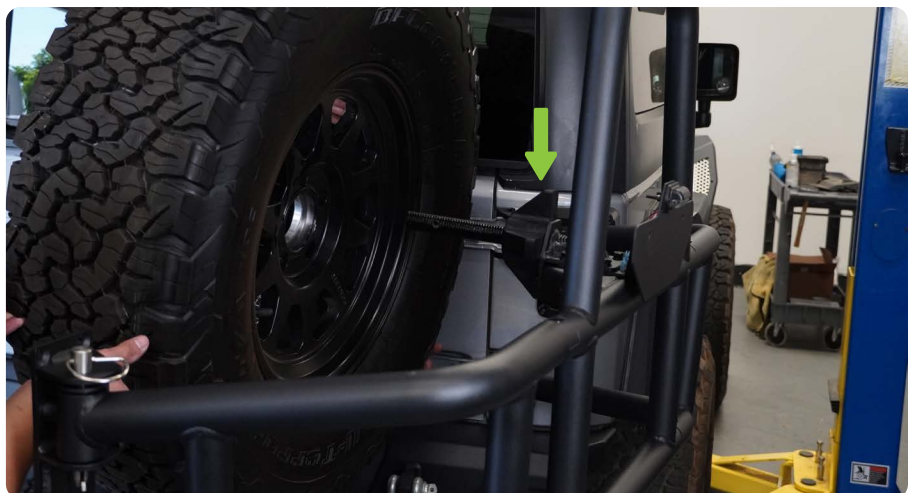

# INSTALLATION MANUAL

**STEP 37** | Install the spindle plate on the back side of the spare tire.



**STEP 38** | Use the T handle to secure the spare tire on to the tire carrier.

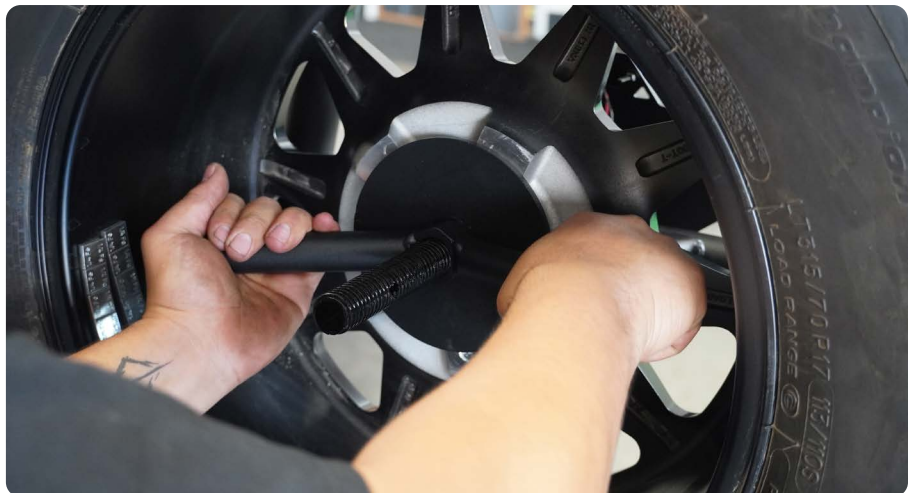

# INSTALLATION MANUAL

**STEP 39** | Attach the provide foam to the back of the driver side mounting bracket.



**STEP 40** | Attach the driver-side bracket to the tire carrier using the provided pins.

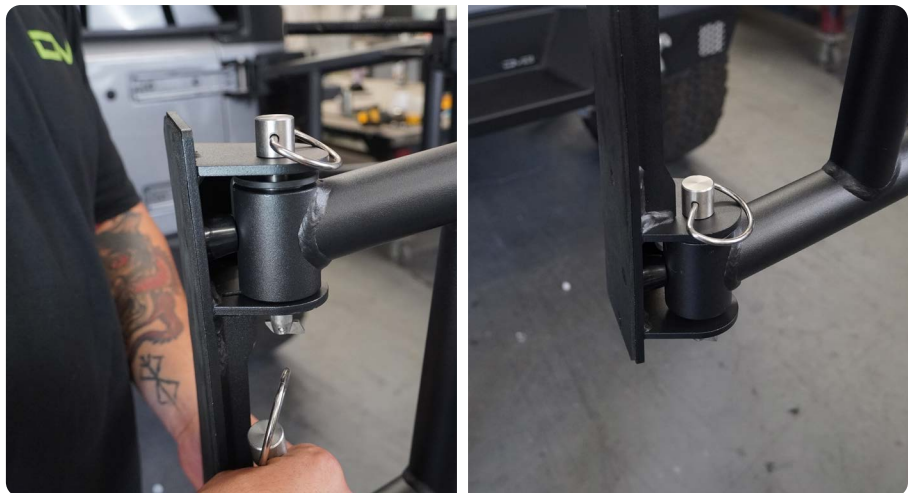

# INSTALLATION MANUAL



**STEP 41** | While the tire carrier is still attached to the mounting bracket (not shown in photo) close the tire carrier and lay the bracket against the body of the vehicle and mark the holes that will need to be drilled out.



**STEP 42** | Use a 3/8" drill bit to drill the marked holes into the body of the vehicle for the tire carrier bracket.



# INSTALLATION MANUAL

**STEP 43** | Mount the driver side tire carrier bracket using the counter sunk M8 hardware.

Use a M8 flat washer and M8 nylon locking nut per M8 counter sunk M8 bolt.



**STEP 44** | Close the tire carrier. If adjustment is needed, turn the cam nut on the top hinge bolt to tilt the tire carrier up or down.

The thicker edge of the cam bolt will tilt the tire carrier up and the thinner edge will tilt the tire carrier down.

**Note:** Ensure both bolt and bottom tire carrier mounting bolts are loose before trying to adjust carrier.



**STEP 45** | Once the tire carrier is adjusted to the desired height, lock the cam bolt in place using a 12mm Allen tool and an adjustable wrench.

Secure the bottom hinge bolt at this time as well.





# INSTALLATION MANUAL

**STEP 46** | Secure all other hinge bolts.

*Note: Do not over tighten to where the carrier becomes difficult to open and close.*



**STEP 47** | Reinstall the driver side tail light with factory hardware and Phillips head screwdriver.



## INSTALLATION MANUAL

**STEP 48** | Using automotive wire, extend the license plate light harness.

Route the extended license plate harness through one of the trunk drain plugs and into the vehicle over to the passenger side.

We recommend using T-taps/wire taps and 18 gauge wire to extend the factory license plate wiring harness so no splicing is required.



**STEP 49** | Continue routing the extended license plate harness behind the tailgate cover into the tailgate and through the vent as shown.



**STEP 50** | Use zip ties to secure the third brake light factory wiring harness, it will not be used with the DV8 tire carrier.





**STEP 51** | Continue routing the extended over and into the tire carrier cage.



# INSTALLATION MANUAL

**STEP 52** | Connect the extended license plate harness to the provided license plate light.

Use the zip tie tabs to secure any loose wiring.



**STEP 53** | The tire carrier cage is equipped with (2) 1/2 inch holes to mount additional accessories such as antennas, LED whips, flags and etc.



# INSTALLATION MANUAL

**STEP 54** | Reinstall any and all plastic interior trim panels.

Double check that all hardware is secure.



**STEP 55** | Congratulations installations of the DV8 tire carrier is complete.

