

SPARE TIRE DELETE

18+ JEEP JL WRANLGER

TSJL-04



TOOLS REQUIRED

- 7, 10, 13mm Socket
- 2.5, #4 Allen Bit
- Philips Head Screw Driver
- Cutting Tool
- Crimping Tool
- Trim Clip Tool
- Lug Nut Tool
- T8, T25, T30 Torx Bit

SKILL LEVEL

- Novice/Intermediate
 - 1 (you) to 2 persons
- Little skill level required, you can easily install it by yourself however, additional help will be useful

TIME REQUIRED

- 2.5 Hour
- Time to install this should only take about two and a half hours.

WARNINGS/CAUTIONS BEFORE STARTING INSTALLATION

Before you install this kit – Read and understand all instructions, warnings, cautions, and notes contained in this installation instruction guide. Consult your vehicle owner’s manual for proper disconnection of electrical and lifting of vehicle if required for installation of this product.

This install may require some technical skills and knowledge of basic mechanical work. If you do not feel that you are capable of performing this install please take this product to a trained professional.

After reading this guide please contact us with any questions or concerns before installing product.
Customer Service: 855-680-9595

DV8 Offroad is not responsible for any bodily injury or harm to you or your vehicle as a result of an improper install.

Proper installation of this kit required knowledge of the factory recommended procedures for removal and installation of original equipment components. We recommend that the factory shop manual and any special tools needed to service your vehicle be on hand during the installation. Installation of this kit without proper knowledge of the factory recommended procedures may affect the performance of these components and the safety of the vehicle

- Always wear eye protection when operating power tools

Inspect all contents of this package to make sure product is not damaged and all installation hardware has been included. If parts are missing from kit, please be prepared to provide the following information

1. Name of purchase location
2. Bar Code on side of box
3. Date above bar code
4. Date inside box cover



INSTALLATION MANUAL

Begin by unpacking all items and inspecting for missing pieces or damage. If you have any concerns, please contact the company the product was purchased from. Extra hardware may be included with the product.

HARDWARE INCLUDED

- | | |
|-----------------------|------------------------------|
| (4) M6x20mm Bolts | (2) M4x15mm Cross Head Bolts |
| (4) M6x14mm Bolts | (8) M4 Flat Washers |
| (5) M6 Lock Nuts | (8) M4 Lock Washers |
| (12) M14 Flat Washers | |
| (2) M4x30mm Bolts | |



STEP 1 | Remove your factory camera/wheel lock using a T30 bit. Turn towards the unlock symbol about half of a turn.



STEP 2 | Remove your spare wheel/tire. Factory lug nuts are a 22mm socket.



INSTALLATION MANUAL

STEP 3 | Open your rear door and using a plastic trim remover tool, pry off the back plate. Pull straight back to avoid breaking off any tabs.



STEP 4 | Unclip the top two plugs to the camera and the third brake light. The white camera plug unclips by pressing the tab down and pulling away. The third brake light will require you to pull back on the red lock tab, then pushing down on the black tab to release.

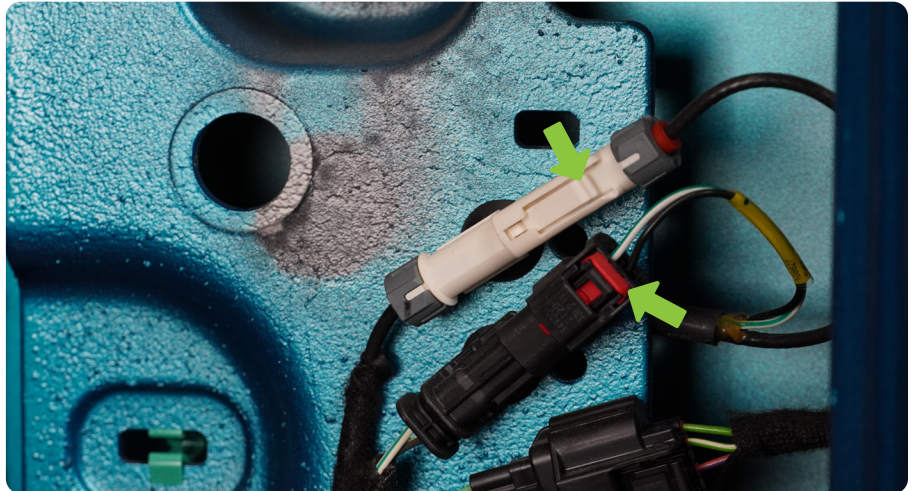

STEP 5 | Using a 13mm socket, remove the eight tire carrier bolts.

NOTE: The carrier will fall away once the last bolt is removed. Ensure you have it secure to avoid paint damage.

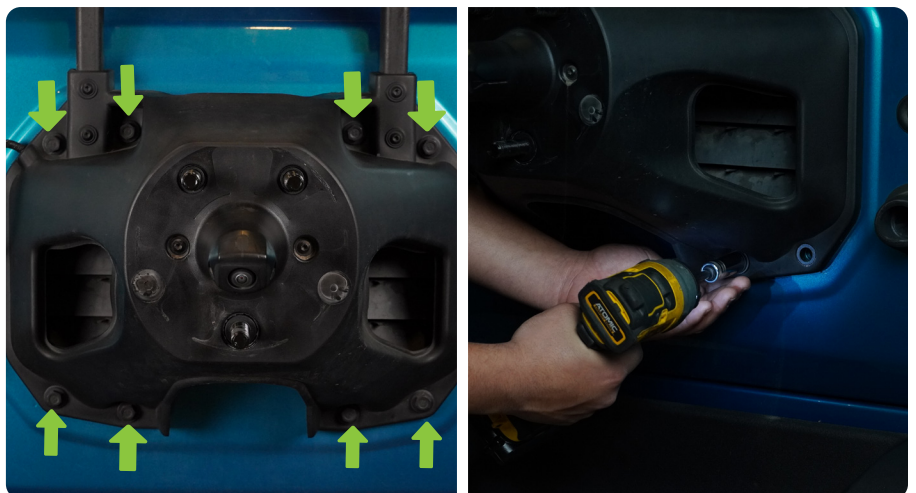

INSTALLATION MANUAL

STEP 6 | Grab the rubber wire grommet and pull away from the door to remove the wires from the door while holding the carrier.



STEP 7 | Once the carrier is removed, place the carrier face up on a soft surface and using a T25, remove the seven bolts under the third brake light.



STEP 8 | Split the front and back of the third brake light housing to gain access to the light mount and the plug. Using the same T25, remove the two bolts holding the light and then unplug the light from the harness. Set all components off to the side.



INSTALLATION MANUAL

STEP 9 | Remove the two bolts on the face of the carrier on either side of the camera tower using your T25. This will allow you to remove the camera and studs.

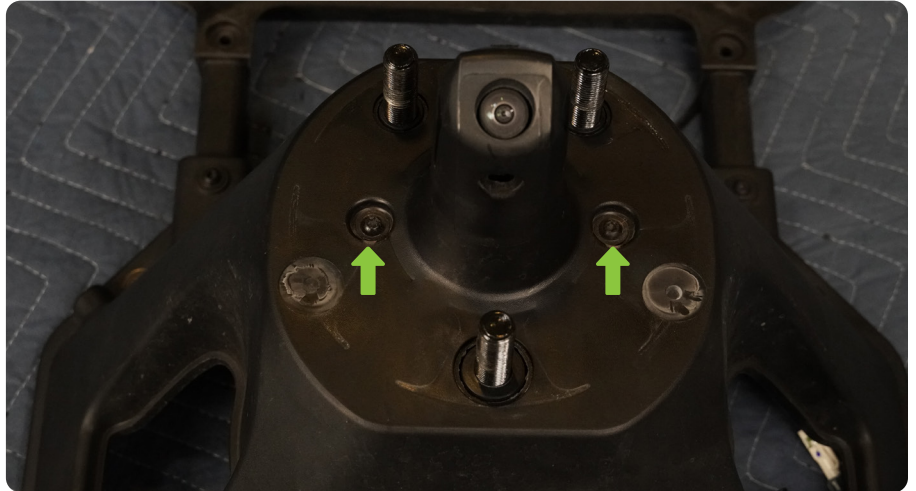

STEP 10 | To remove the stud plate, tap on the studs evenly with a hammer or mallet to push them through the carrier. The stud plate should fall away from the camera mount and carrier.



STEP 11 | Once free, using a socket or in our case a 3/8" socket extension, we tapped lightly on the exposed camera mounts in each stud hole. We also reinserted each T25 screw just to the left and right of the camera tower and tapped on these. The camera mount is not glued but pressed in slightly so some light force may be needed to release it.



INSTALLATION MANUAL

STEP 12 | Remove the wire harness from the stud plate. Clip the zip tie to release the wire



STEP 13 | Pull the camera mount from the carrier and using a T8 Torx bit, remove the camera from the mount and unplug from the harness and set everything off to the side.

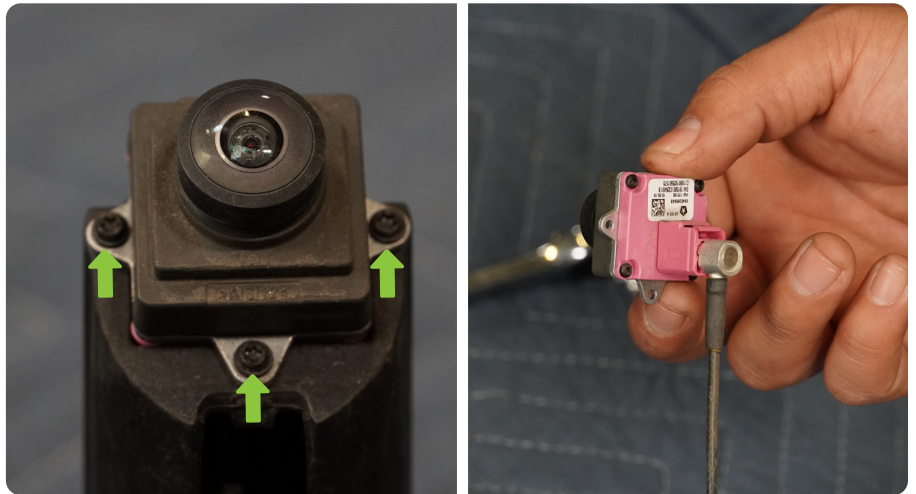

STEP 14 | Reopen the rear door, and using a flat head screwdriver, push down the two clips on the top of each rear exhaust vent while pulling from the outside to remove the vents.



INSTALLATION MANUAL

STEP 15 | You will need to use snips or a grinder to remove the lip from each vent so that they appear flat from the outside.



STEP 16 | Replace the vents into the door by clipping them into place from the outside pushing towards the inside.



STEP 17 | Place the provide foam piece on to the body mounting plate.

Place the thicker foam piece on the side of the mounting plate that rest against the vehicle.



INSTALLATION MANUAL

STEP 18 | Use the provided M4 hardware, #2.5 Allen and an 7mm socket to mount the third brake light.



STEP 19 | Mount the provided license plate light using the provided M4 Philips head hardware and lock nuts.

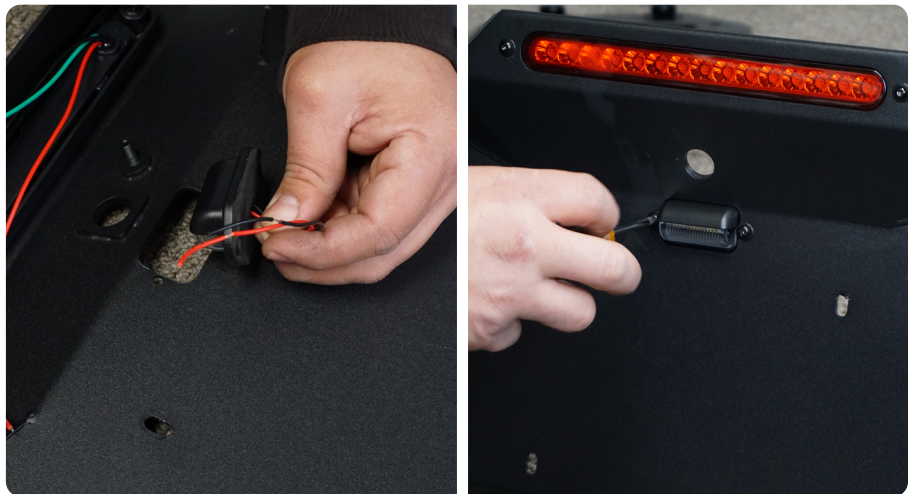

STEP 20 | Use the provided M6 hardware and an #4 Allen bit to mount the license plate.



INSTALLATION MANUAL

STEP 21 | Mount the back up camera, use the provided bracket and M6 lock nut to secure the camera in place.

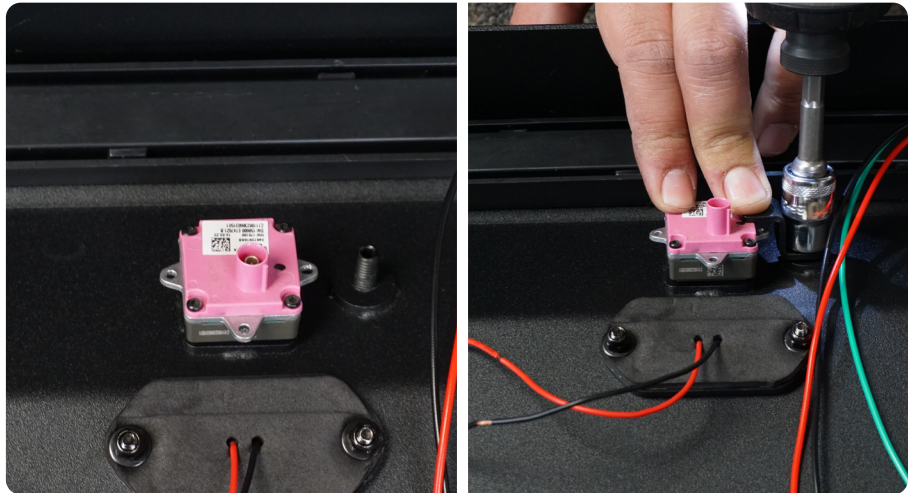

STEP 22 | Using the provided wiring harness plug and weather proof crimps, connect the harness plug to the third brake light.

The green wire will not be used. This can be cut short and capped.

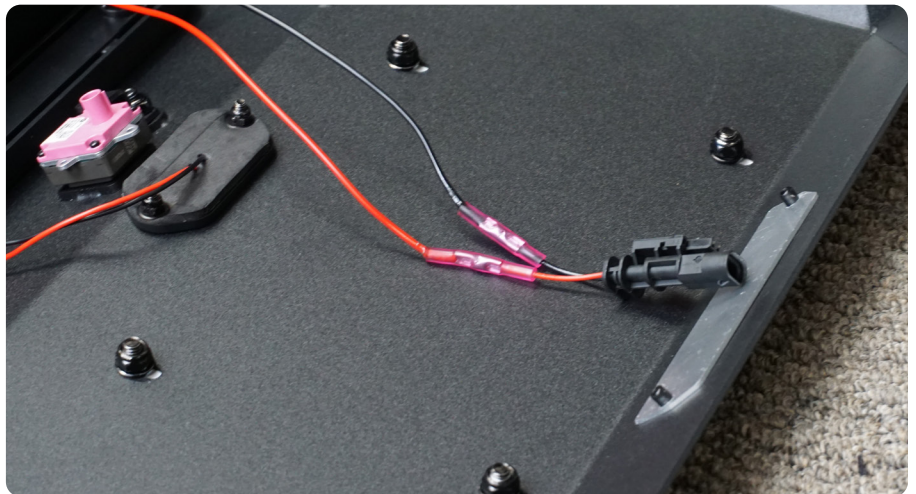

STEP 23 | Connect the license plate light to the provided wiring harness using the provided weather proof crimps.

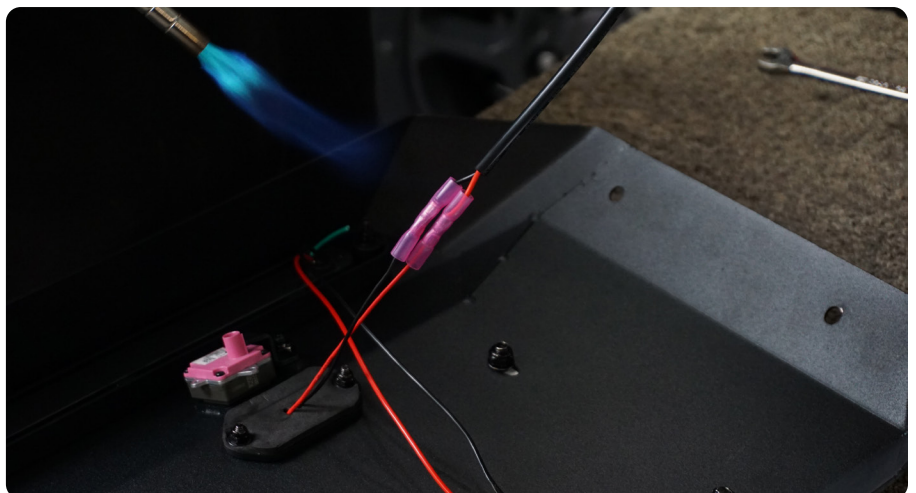

INSTALLATION MANUAL

STEP 24 | Remove both factory bumper isolators.

Use (4) of the factory tire carrier bolts to mount the DV8 Body mounting plate.



STEP 25 | Push the factory wiring harness back through the hole in the tailgate.

Plugs are provided to seal these factory tailgate holes.



INSTALLATION MANUAL

STEP 26 | Route the DV8 license plate wiring harness through the tailgate vents.

For this install the vents are not present to provide a clear understanding of the harness install.

Re-connect the camera prior to securing the face plate.

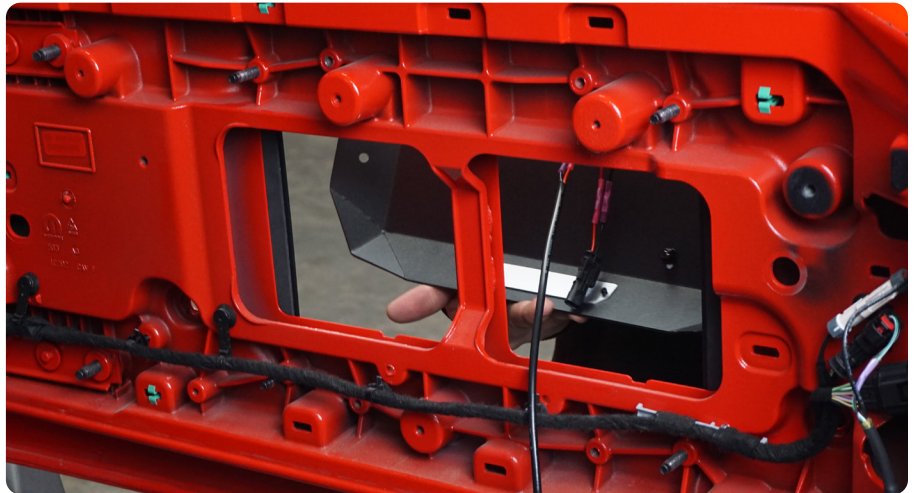

STEP 27 | Using the provided M6 hardware and a #4 Allen bit, mount the spare tire face plate to the body mounting plate.



INSTALLATION MANUAL

STEP 28 | Connect the factory third light harness to the DV8 third brake light.

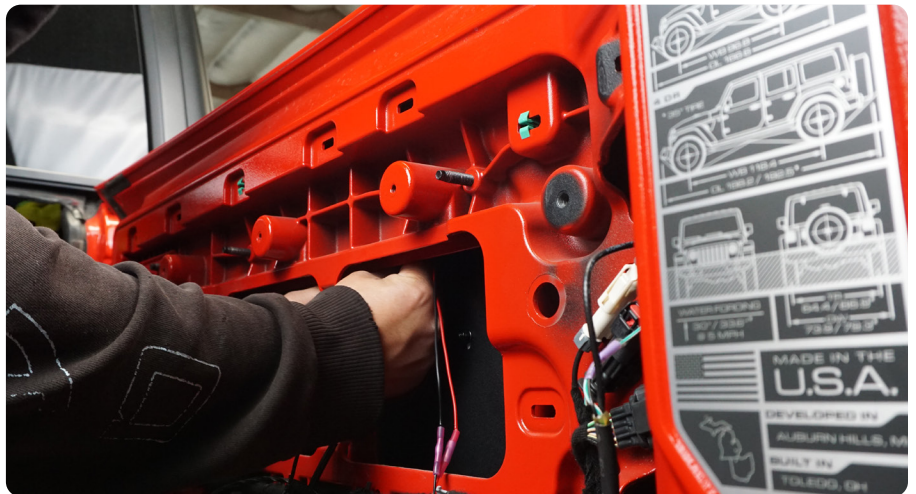

STEP 29 | Use the provided rubber plugs to seal the factory tail gate holes.

Tech Tip: Use a small amount of glass cleaner to assist installation of the rubber plugs.



INSTALLATION MANUAL

STEP 30 | Route the DV8 license plate wiring harness along the factory wiring harness into the vehicle.

Secure it to the existing wire loom using zip ties for a clean install.

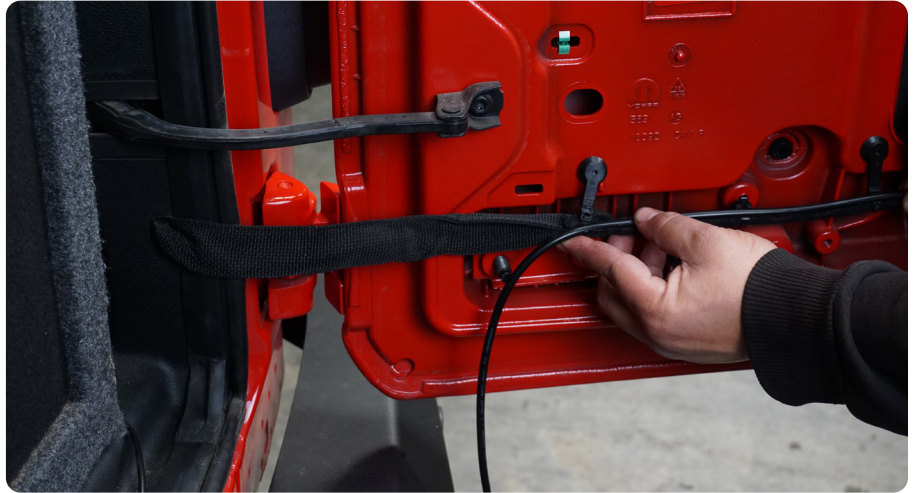

STEP 31 | Push the DV8 license plate wiring harness down and behind the interior trim so that it can be pulled from under the carpet.



STEP 32 | Route the DV8 License plate light harness under the carpet and over to the drivers side.

Cut the factory license plate light harness connector at the correct length once it is routed near the factory harness.

Use provided weather proof crimps to connect factory licenses plate light harness to the DV8 license plate light harness.

Secure any loose wiring using zip ties.

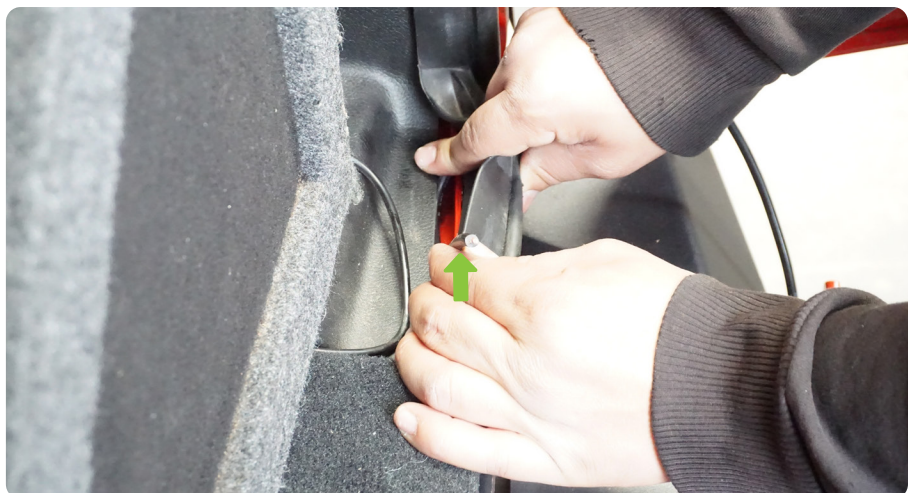

INSTALLATION MANUAL

STEP 33 | Reinstall the tail gates interior trim panel.

Be-careful not to damage any factory clips.



STEP 34 | Ensure that all hardware is secure and double check function of all lighting and the camera.

Congratulations installation of the DV8 spare tire delete is complete.

